



Hallfield Estate, London, W2 6EE
£2,500 Per Month





2 x  1 x  1 x 

Braithwait is please to present this spacious two bedroom flat situated on the top floor with a lift in the building of the well known listed building at the Hallfield Estate. The property comprises two double bedrooms, a separate reception room and kitchen, bathroom and separate WC, and two storage cupboards.

Available now



Bridgewater House, Hallfield Estate, London W2
Approximate Gross Internal Area
702 sq ft - 65 sq m

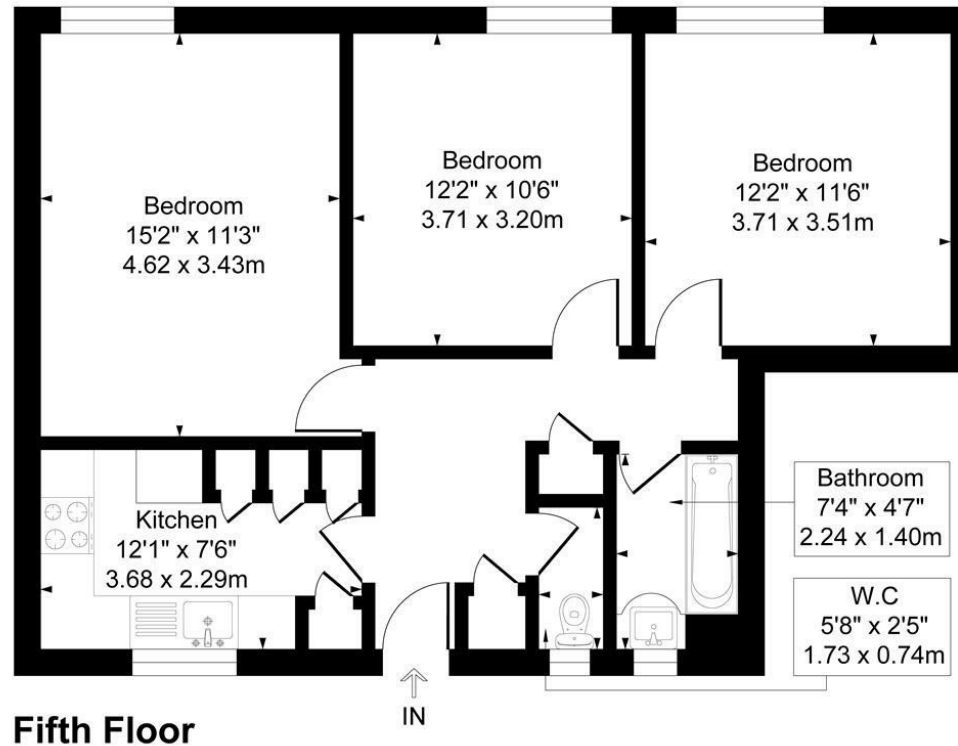
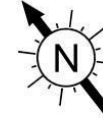

Fifth Floor

Illustration for identification purposes only, not in scale

Important Notice Debussy Property Service Ltd trading as Braithwait for themselves and for the vendor of this property whose agents they are, give notice that (i) these particulars do not constitute any part of an offer or contract, (ii) all statements contained within these particulars are made without responsibility on the part of Braithwait or the vendor, (iii) whilst none in good faith, none of the statements contained within these particulars are to be relied upon as a statement of representation or fact, (iv) any intending purchaser must satisfy him/herself by inspection or otherwise as to the correctness of each of the statements contained within these particulars, (v) the vendor does not make or give either Braithwait or any person within their employment any authority to make or give any representation or warranty whatsoever in relation to this property. Wide angled lenses may be used in photographs.

Call us on 0207 289 8889 or email sales@braithwait.co.uk

